

D.C. geared motors

- D.C. geared motors : 0.3 to 430 rpm
- Gearbox torque ratings from : 0.5 to 2 Nm, high-performance plastic gears
- Motors : max. usable power 1 to 3.9 W interference suppression on standard products

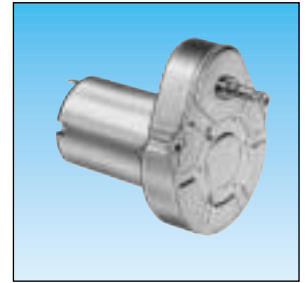
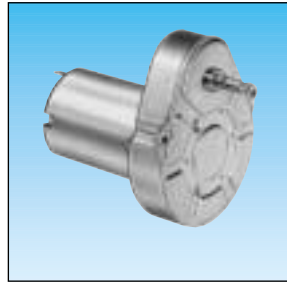

Applications

- Blood analysers
- Machines for making spectacle lenses
- Microvalves for heating systems
- Change-giving systems
- Packaging machines
- Moving light displays
- Etc.

Made to order products, available on request

Motors :

- other supply voltages
- motors with 2 ball bearings
- shaft lengths at front and/or rear
- connection by radial tags or leads
- specific interference suppression
- encoder : 5 or 12 pulses per revolution

Gearboxes :

- special shaft
- ball bearings
- special lubrication
- friction clutch
- M3 gearbox fixings
- other speeds

Types

		82 861 0	82 861 0	82 841 0	82 841 0
Nominal voltage		12 V	24 V	12 V	24 V
Output speeds (rpm)	Ratios (i)	Part numbers			
430	10	82 861 006	82 861 015	•	•
215	20	82 861 007	82 861 016	•	•
179	24	•	•	•	•
143	30	82 861 008	82 861 017	•	•
108	40	82 861 009	82 861 018	•	•
90	48	•	•	•	•
54	80	82 861 010	82 861 019	•	•
49	90	•	•	•	•
29	150	•	•	•	•
27	160	—	—	—	—
22	200	82 861 011	82 861 020	•	•
13	320	—	—	—	—
11	375	82 861 012	82 861 021	•	•
8.6	500	82 861 013	82 861 022	•	•
7.2	600	—	—	—	—
5.8	750	•	•	•	•
5.4	800	—	—	—	—
3.6	1200	82 861 014	82 861 023	•	•
2.9	1500	—	—	—	—
1.8	2400	•	•	•	•
0.90	4800	—	—	—	—
0.80	5400	•	•	•	•
0.36	12000	•	•	•	•

Standard gearbox shaft : see dimensions

General characteristics

		82 860 0	82 860 0	82 840 0	82 840 0
Motor		82 860 0	82 860 0	82 840 0	82 840 0
Gearbox		81 021 0	81 021 0	81 021 0	81 021 0
Maximum permitted torque on gearbox for continuous rating (for 1 million revolutions)	Nm	0.5	0.5	0.5	0.5
Axial load (static)	daN	1	1	1	1
Radial load (static)	daN	8	8	8	8
Maximum usable power	W	3.9	3.9	1	1
Maximum usable power	W	3	3	0.9	0.9
Gearbox case temperature rise	°C	50	50	50	50
Weight	g	160	160	130	130

Options : for standard products non stocked

Output shaft Ø 4 mm	79 200 967	•	•	•	•
	79 200 779	•	•	•	•
Ø 6 mm	70 999 421	•	•	•	•
	79 202 573	—	—	—	—
With magnetic encoder 1 pulse per revolution		82 861 5	82 861 5	—	—

Nominal speed and torque curves

The shaded zone represents the operating range of the geared motor.

The horizontal line marks the maximum torque available in continuous duty cycle for a given life.

For higher torque ratings, service life will be reduced.

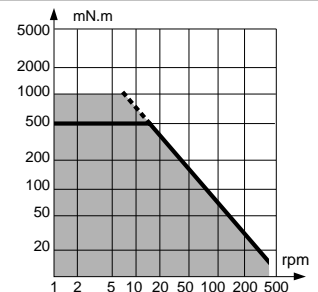
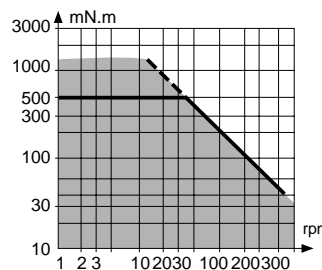

Other information

Basic principles : see page 1/7.
Motor 82 840 0, 82 860 0 : see page 1/9.

